

Assembly Instructions:

1. Disassemble the scope ring.
2. Place parts (A) and (B) around scope tube.
3. Insert screws (1) and tighten completely. There should be no gap at bottom of the ring.
4. Insert (4) springs in the screw holes.
5. Place (C) plate over springs and tighten with (3) screw or with lever assembly.
6. You should repeat this with the next ring.
7. Place the scope on the bases. Tighten the locking plate. This will secure the ring on the base. You can square up the scope and adjust for proper eye relief at this time.
8. Insert (2) screw(s) and tighten.

KEEP ALL ASSEMBLY NUMBERS APPEARING ON THE BOTTOM OF THE RING TOGETHER

Lever Adjustment:

Note the levers should point toward one another. You can gain this by rotating the lever around the screw.

DETACHABLE SCOPE RING ASSEMBLY INSTRUCTIONS



Talley Mfg.
 P.O. Box 369
 9183 Old Number Six Highway
 Santee, SC 29142
 Phone: (803) 854-5700 • Fax: (803) 854-9315
"Made to a Standard, Not to a Price"

- | | | |
|--------|-------|-------------------|
| No. 1, | | - 6/48 |
| No. 2, | | - 6/48 |
| No. 3, | | - 10/32 |
| No. 4, | | Springs |
| No. 5, | | 10/32 Lever Screw |
| No. 6, | | Lever |

**View #2
Front**

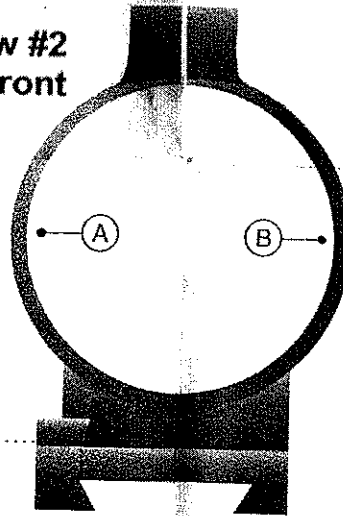

**View #3
Assembled**

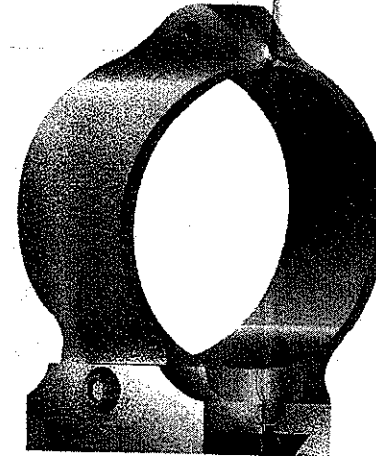

***NOTE: Ring together at bottom.**

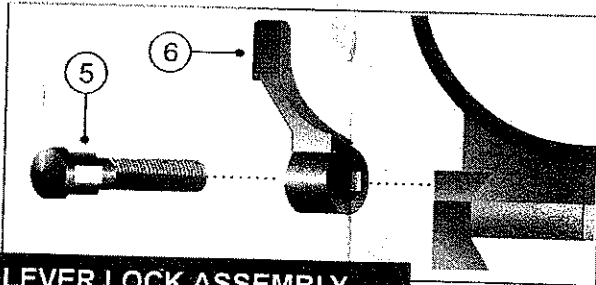

LEVER LOCK ASSEMBLY
 No.'s 5 & 6 can replace #3.

**View #1
Exploded**

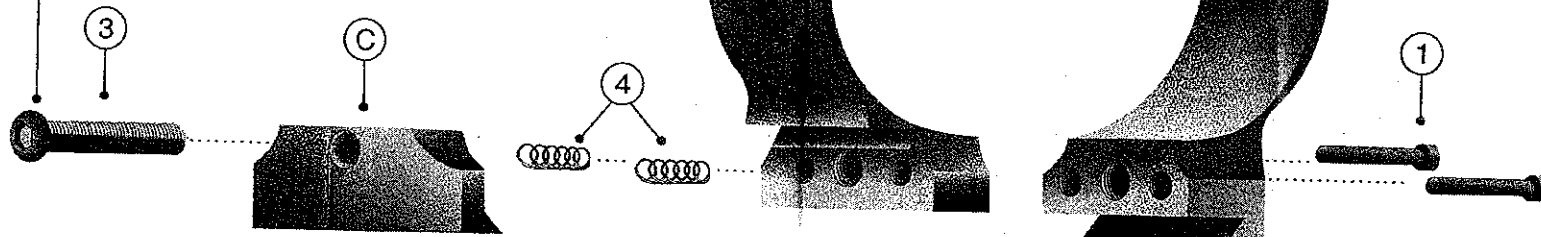

#TM101

For Technical Assistance, please call: Talley Mfg. at 803-854-5700